

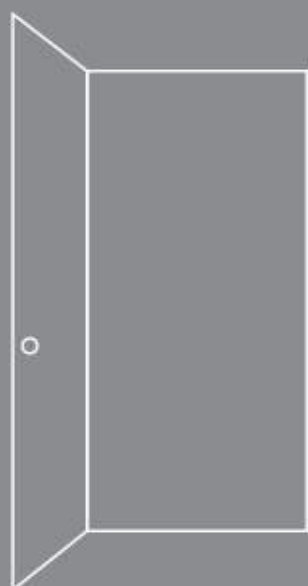

SIDDHIVINAYAK
PROSPERA

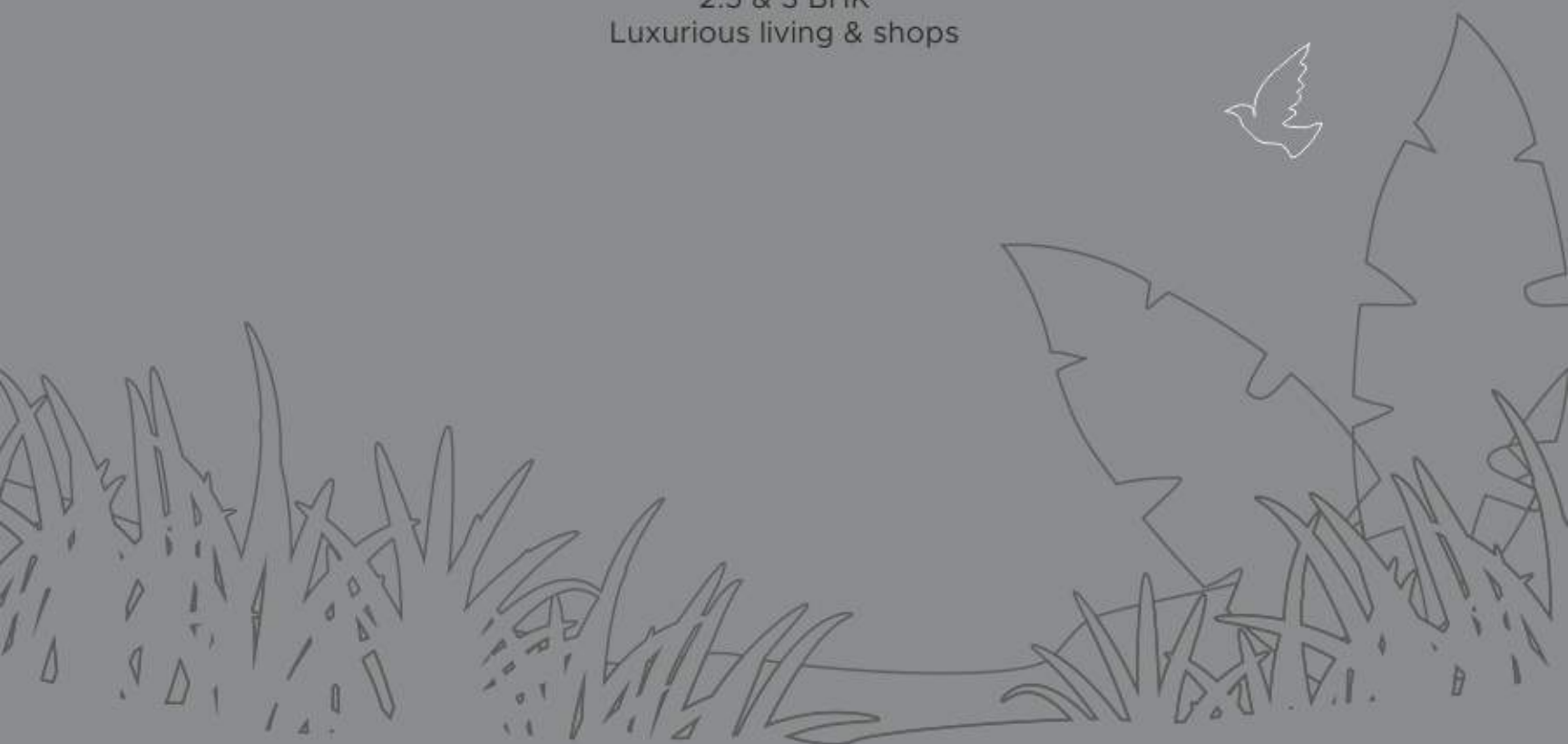

2.5 & 3 BHK
Luxurious living & shops



Raise your lifestyle
beyond your dreams





Siddhivinayak Prospera Your new gateway to prosperity

Own home or place of a business is a very pious dream for Indian families. The virtuous land has a capacity to create fortunes. Siddhivinayak Prospera is a project that is designed to lead you on the pathway to prosperity.





ATTRACTIVE
ENTRANCE GATE



24X7 SECURITY
WITH CCTV



FIRE SAFETY
PROVISION



ATTRACTIVE
ENTRANCE FOYER



CLUB HOUSE

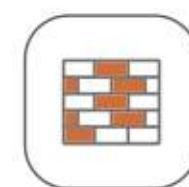

DESIGNER
COMPOUND WALL



LANDSCAPE GARDEN



JOGGING TRACK



SENIOR CITIZEN
SIT OUT



WATER BODY



MULTIPURPOSE HALL



OPEN AIR
THEATER



YOGA DECK



PROVISION FOR AC IN
ALL BEDROOMS & HALL



INDOOR GAMES



WIDE STAIRCASE



KIDS PLAY AREA



2 AUTOMATIC
ELEVATORS IN EACH BLOCK



PARTY LAWN



GAZEBO



SOLAR POWER FOR
COMMON LIGHTING



DTH SATELLITE
TV CONNECTION



VASTU COMPLIANT
EAST-WEST ENTRY



DG BACK UP FOR
COMMON AREAS



- | | |
|----|--------------------|
| 1 | ENTRY |
| 2 | SECURITY CABIN |
| 3 | LAWN AREA |
| 4 | SEATING AREA |
| 5 | MULTIPURPOSE COURT |
| 6 | HALL |
| 7 | HOME THEATRE |
| 8 | WASH AREA |
| 9 | YOGA DECK |
| 10 | WATER BODY |
| 11 | SCULPTURE |
| 12 | PLAZA |
| 13 | AMPHITHEATRE |
| 14 | STAGE |
| 15 | PLAY AREA |
| 16 | SAND AREA |
| 17 | FOUNTAIN |



12M WIDE ROAD







BLOCK - A & B
TYPE - 1 | 3 BHK



SIDDHIVINAYAK
PROSPERA

BLOCK - A & B
TYPE - 2 | 3 BHK



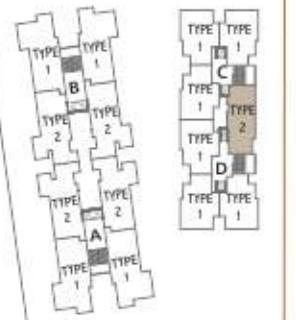
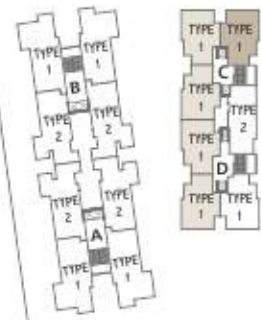



Spacious & Full of Positivity
Lead your family to eternal happiness

Carefully planned and blessed with a plethora of amenities, Siddhivinayak Prospera can help you steer your life towards the contented successful lifestyle that you and your family deserve.



Structure

- Quality controlled earthquake resistant, RCC framework structure.
- Basement for ample car parking facility.
- Professionally water-proofed terrace.



Flooring & Tiling

- Premium quality vitrified flooring in drawing room, dining, all bedrooms, balcony, utility area & kitchen.
- Platform-Mirror polished granite with S.S. Sink.
- Decorative tile dedo upto lintel level on the walls above platform in kitchen and wash area.
- Bathroom walls-decorative tiles dedo upto lintel level.



Doors & Windows

- Main entrance door with decorative laminate and hi-quality locking arrangement.
- Internal flush doors with wooden frames & premium SS hardware & handles.
- High quality heavy gazed domel aluminium windows.
- Granite jams for all windows.



Plumbing & Sanitation

- Premium quality sanitary ware & fittings in all bathrooms.
- Hi-quality concealed CPVC/UPVC plumbing lines.



Electrical

- 3-phase concealed electrical copper cabling (ISI, Fire Resistent) with ample electrical points with MCB & ELCB.
- Premium quality modular switches.
- Provision for DTH-TV connectivity.
- Provision for high-speed internet connectivity.
- Geyser points for all bathrooms.



External & Internal Finishes

- External : Plaster with acrylic paint.
- Internal : Single coat mala plaster with putty finish.



Common Area

- 2 High speed Elevators each block.
- Stone finished staircase with MS Railing.

NOTES

Stamp Duty & Registration charges would be charged extra · GST and any such additional taxes would be charged extra · Maintenance contribution would be charged extra · The member can make internal changes, and can't make changes externally which affects the building elevation · Terrace rights would rest with Developers · Any additional FSI at present or in future would be availed by the developer and no member would claim any right for the same · Gas, UGVCL, Underground Drainage & Water connection charges would be extra · At the time of cancellation of booking 10% service charge of the total amount paid shall be levied & balance payment made only after the next available booking · This brochure is for information purpose only · All the dimension, architectural views and photographs are for reference only · This brochure does not form a part of the agreement or any legal document · The printed images are the artistic impression.

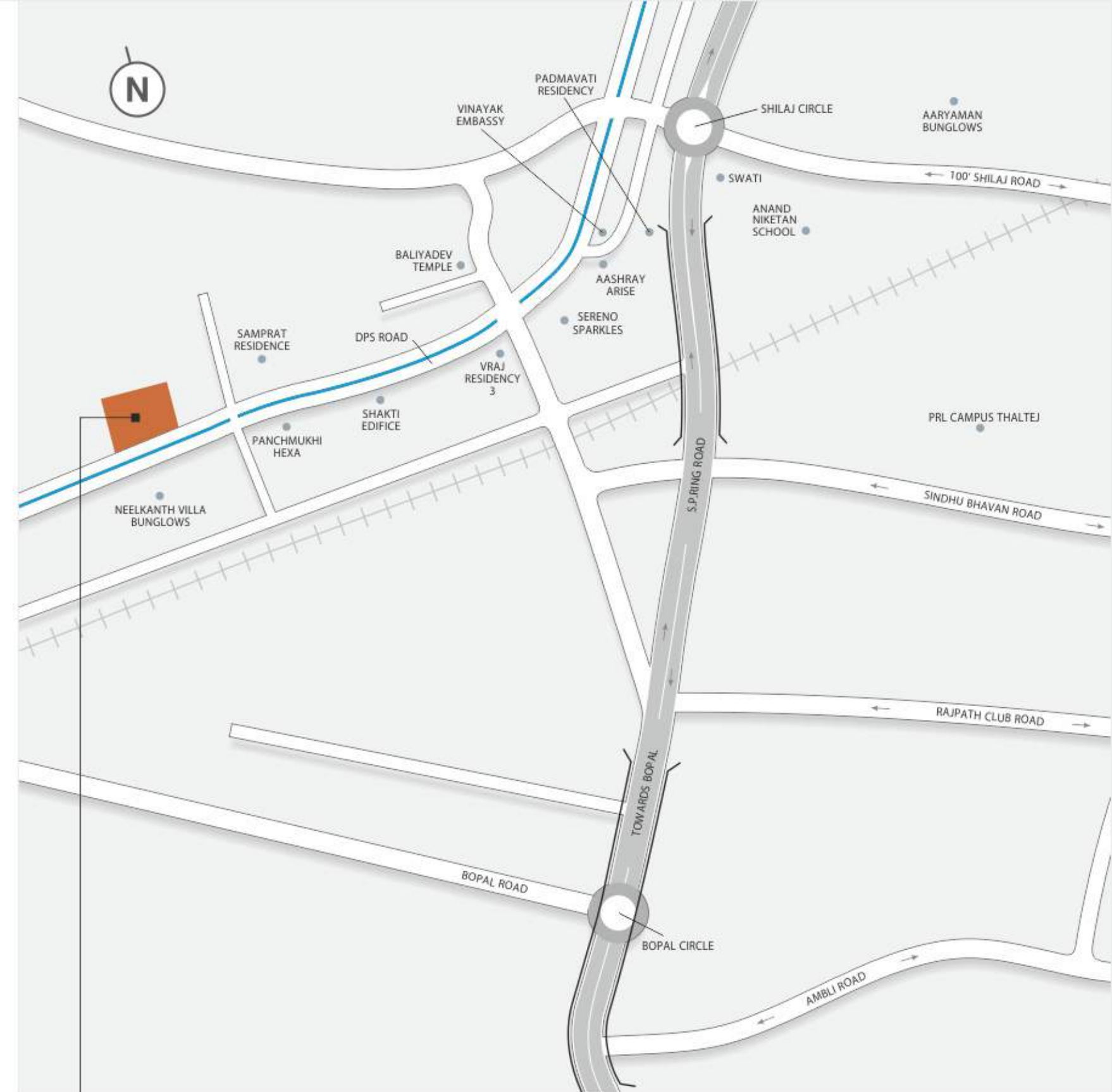

Nr. Samprat Residency, Opp. Nilkanth Villa Bungalows
Shilaj - DPS Canal Road, North Bopal, Ahmedabad - 380058

+91 76001 31616, +91 93136 00895

Rera No. PR/GJ/AHMEDABAD/AHMEDABAD CITY/AUDA/MAA10911/121122
Website: www.gujrerar1.gujarat.gov.in



Scan for Location

PROJECT BY
SHREE
RUDRANSH
BUILDSCAPE LLP

ARCHITECT
S.MEVADA
ARCHITECTS

STRUCTURE
Dip Structural
Consultant

MEP CONSULTANT
Amtech Consultant

LANDSCAPE

THE LANDSCAPES



Scan for Brochure

www.*****.com

